

# Instructions Manual

## Simus

WKE036.4.Axx

Electric Beauty Bed

VERSION 7.25

# 1.Welcome!

Congratulations on purchasing this new electric beauty bed.

To ensure your proper use of the WKE036.4.Axx Beauty Chair, please read this manual.

The illustrations used in this manual are intended to illustrate the product's operation.

Please keep this manual properly for future reference.

## 2.Warnings and precautions

- Never under any circumstances attempt to open or inspect the internal components of the bed. If an inspection becomes necessary, please contact your supplier or a suitably competent technician.
- Never use the bed in humid or poorly ventilated environments, such as wet rooms, bathrooms etc. to prevent damage to the electrical components. Any prolonged exposure to high moisture conditions may affect the electrical components and may result in failure.
- Never use the unit outdoors; exposure to the elements can cause damage.
- If the power cord was destroyed, please ask a professional to service and replace it to avoid hazards or contact the dealer for service.
- The maximum allowed lifting limit is around 180 kg. Do not exceed this weight.
- Always ensure that the bed is used within the correct electrical voltage range. Unless otherwise requested, beds are manufactured 220-240v rated and should be used with the same rated supply.
- When the bed is placed for use, always ensure that the power cord is in such a way, that it will not get caught in the moving parts or jammed under the bed or any other little piece of furniture nearby.
- Children are not allowed to use the bed or be near the equipment while it is on use. Do not leave children unsupervised near the bed.
- Always take care to avoid anyone sitting on the head or leg parts of the bed since this will cause damage to the bed and its electronic, hydraulic and mechanical functions.
- When lifting your bed for moving it, always lift by the metal frame beneath the casing at each side. Unplug it prior to any movement. 2 or more persons should move the bed due to its size and weight.

# 3.Product specifications



## Optional accessories

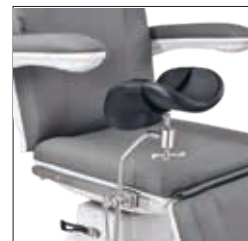

Product size: 1850 x 620 x 520-870mm

Backrest angle: 85°

Seat inclination angle: 12°

Footrest angle: 85°

Net Weight: 84Kg

Gross Weight: 89Kg

Maximum load: 180Kg

Power: AC 220-240V, 50/60Hz

Maximum Power: 300W

## 4.Operation

### Switch Panel:

1. Ensure the power cord and hand controller or foot controller are properly inserted in the correct direction and locked as indicated by the arrow.
2. Turn on the power switch; the indicator should be steadily lit.
3. If the device shows no response, turn off the power, open the fuse box, check the fuse, and replace it if necessary.

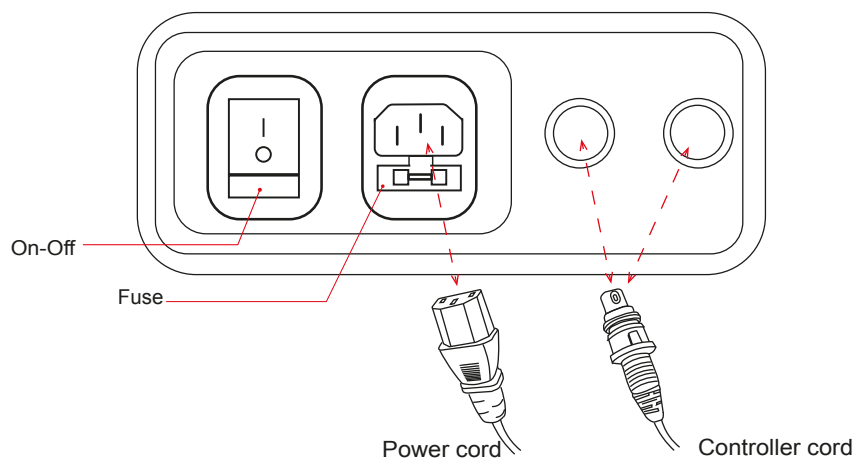

## Backrest control button:

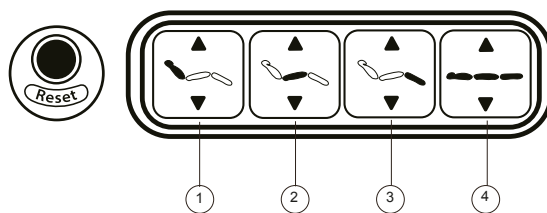

## Hand controller:

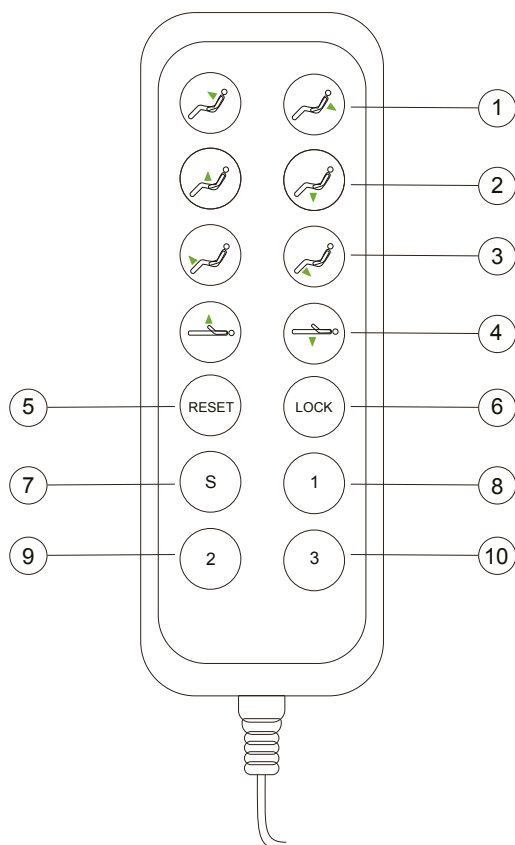

- 1 Press or button to control the lifting angle of the backrest of the chair.
- 2 Press or button to control the tilting angle of the cushion of the chair.
- 3 Press or button to control the lifting angle of the footrest of the chair.
- 4 Press or button to control the rising or lowering of the whole chair.
- 5 Press and hold the button for 3 seconds to reset motor. The backrest will automatically move to the maximum; the height of the whole chair will be lower to the greatest extent; the cushion will automatically move to the maximum; and the leg pad will move to the minimum.
- 6 In the active state, press the button to secure the system, disabling all buttons. To reactivate the buttons, press again while in the locked state.
- 7 Press the button to record the position. If you press the number key the current position of the actuator will be memorized as position 1. Other number keys have the same function.

- 8 Press number key and hold for 3 seconds, it will automatically move to position 1 which has been memorized, and you can press any button to quit this mode and stop the actuator operation.
- 9 Press number key and hold for 3 seconds, it will automatically move to position 2 which has been memorized, and you can press any button to quit this mode and stop the actuator operation.
- 10 Press number key and hold for 3 seconds, it will automatically move to position 3 which has been memorized, and you can press any button to quit this mode and stop the actuator operation.

### Security System:

The WKE036.4.Axx Beauty Chair integrates a security system with the reset button to avoid hazards from the pull-out footrest.

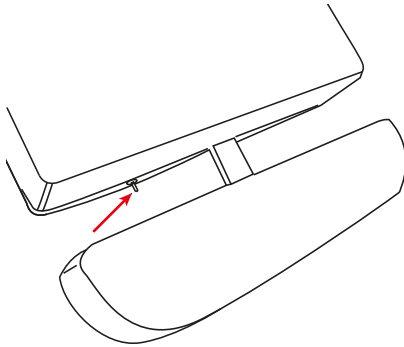

When the footrest extends, a safety button pops out—disabling the reset button and preventing the bed from lowering to minimum height. This keeps the extended footrest clear of the ground.

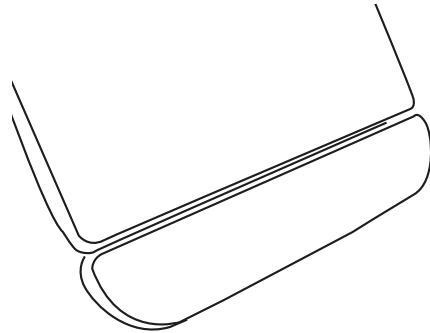

Retract the footrest fully to reactivate the reset button and restore full height adjustment. This resets the safety button.



# 5.Maintenance

## 1. Daily Cleaning:

- Gently wipe away dust from the product surface using a soft, dry cloth.

## 2. Stain Removal:

- For stubborn dirt that won't come off with a regular dry cloth, use a soft towel dampened with a diluted neutral cleaner. After cleaning, dry the area thoroughly with a clean, dry cloth.

## 3. Avoid Solvents:

- Refrain from using solvents such as benzene, thinners, or gasoline, as these can damage the product's leather or erode the surface of the product casing.

## 4. Storage and Usage Conditions:

- Keep the product out of direct sunlight and humid environments to prevent damage.
- The product is designed to operate in temperatures ranging from -5° C to +50° C and at a relative humidity of 45% to 85%.

## 5. Routine Maintenance:

- Regularly lubricate moving parts (annually) to ensure smooth operation and prolong the product's lifespan.

Please adhere to these maintenance tips to maintain the product's performance and appearance over time.

# 6.Troubleshooting

Please try the following fault diagnoses and eliminating operations if you find a fault in your using thisproduct.

Phenomenon	Diagnosis	Eliminating Operations
Press the control key but nothing happens to the bed	1.The function of the pressed control key has been switched to the extremity; 2.Whether the power plug is properly inserted; 3. Whether all connecting plugs of the transformer are inserted properly; 4.Quality problem of manual control board.	1.Try to press other control keys; 2.Unplug the power plug and replug it; 3.Unplug and replug; 4.Replace the manual control panel.
Abnormal sound and shaking during the lifting and lowering of the chair	1.The screws are loose 2.All the rotational components are lacking of lubricating oil 3.Quality problem of motor	1.Tighten all screws 2. Add some lubricant 3.Replace the motor

# 7. Gynecology accessory

To assemble the gynecology legrests accessory, you need to attach the bars to both sides of the bed.

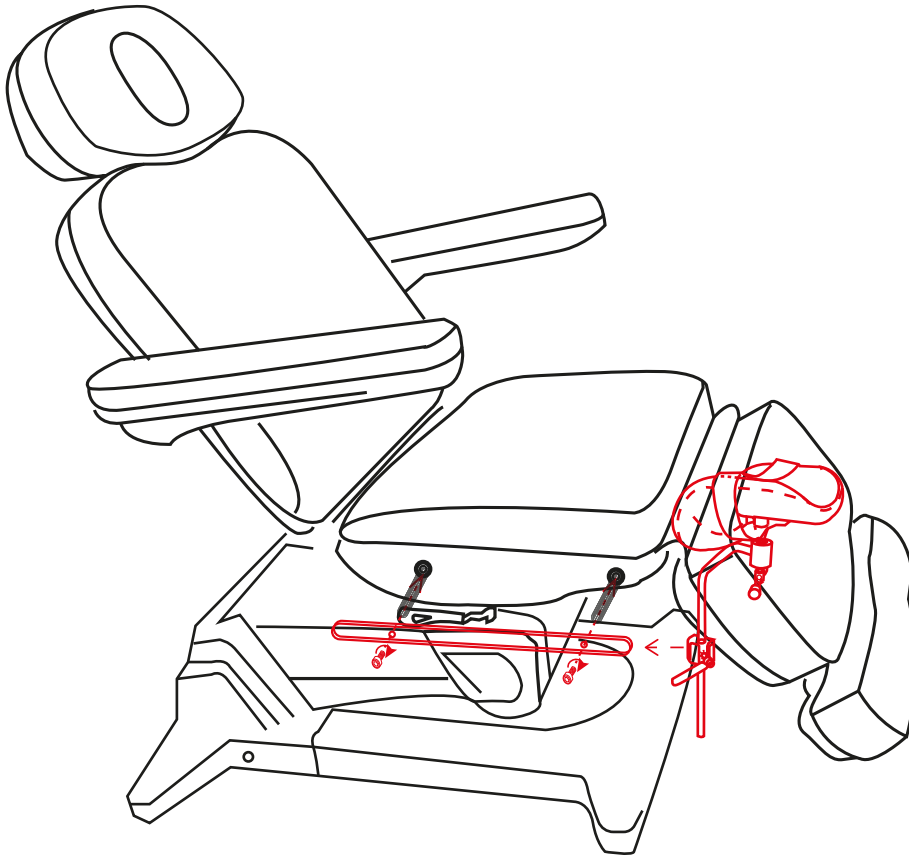

You can graduate the position of the legrest using the bar.  
And adjust the inclination in order to get the most ergonomic position for the patient.  
The legrest has removable straps to secure the patient's leg.

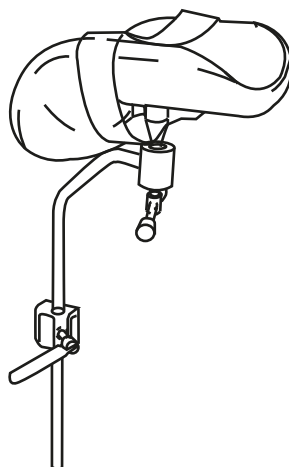



# 7. Foot pedal accessory

To assemble the foot pedal accessory, you need to attach the controller to the sides of the bed base, and connect the cable as indicated in the following drawing:

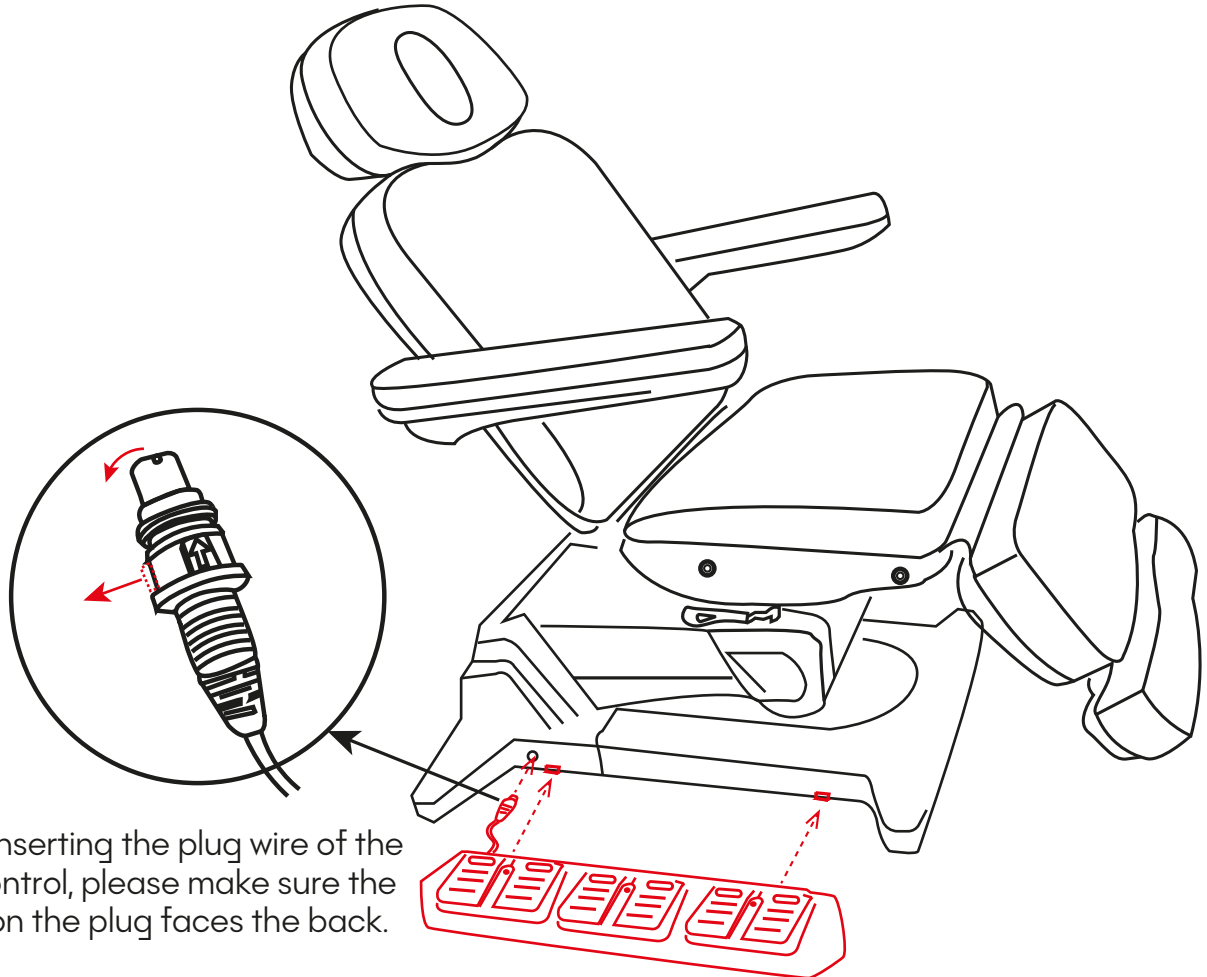

When inserting the plug wire of the foot control, please make sure the arrow on the plug faces the back.

(Valid for both sides of the foot pedal accessory connector) !!

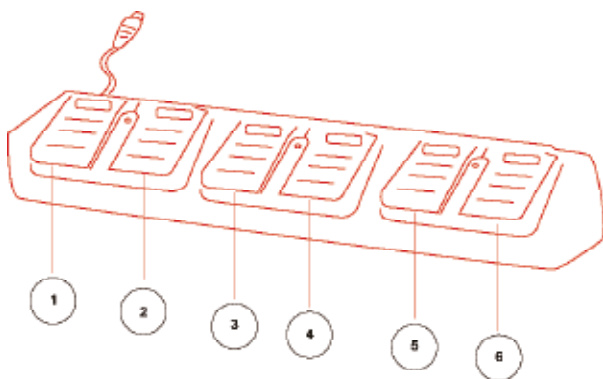

1. Step on button 1, the back angle will increase.
2. Step on button 2, the back angle will decrease.
3. Step on button 3, the bed height will increase.
4. Step on button 4, the bed height will decrease.
5. Step on button 5, the seat inclination will increase.
6. Step on button 6, the seat inclination will decrease.

## Product Maintenance Guide:

### 1. Daily Cleaning:

- Gently wipe away dust from the product surface using a soft, dry cloth.

### 2. Stain Removal:

- For stubborn dirt that won't come off with a regular dry cloth, use a soft towel dampened with a diluted neutral cleaner. After cleaning, dry the area thoroughly with a clean, dry cloth.

### 3. Avoid Solvents:

- Refrain from using solvents such as benzene, thinners, or gasoline, as these can damage the product's leather or erode the surface of the product casing.

### 4. Storage and Usage Conditions:

- Keep the product out of direct sunlight and humid environments to prevent damage.
- The product is designed to operate in temperatures ranging from -5°C to +50°C and at a relative humidity of 45% to 85%.

### 5. Routine Maintenance:

- Regularly lubricate moving parts (annually) to ensure smooth operation and prolong the product's lifespan.

Please adhere to these maintenance tips to maintain the product's performance and appearance over time.

## Fault Diagnosis.

Please try the following fault diagnoses and eliminate operations if you find a fault when you are using this product.

Phenomenon	Diagnosis	Eliminating Operations
Press the control key but nothing happens to the bed	1.The function of the pressed control key has been switched to the extremity; 2.Whether the power plug is properly inserted; 3. Whether all connecting plugs of the transformer are inserted properly; 4.Quality problem of manual control board.	1.Try to press other control keys; 2.Unplug the power plug and replug it; 3.Unplug and replug; 4.Replace the manual control panel.
Abnormal sound and shaking during the lifting and lowering of the chair	1.The screws are loose 2.All the rotational components are lacking of lubricating oil 3.Quality problem of motor	1.Tighten all screws 2. Add some lubricant 3.Replace the motor



Imported by  
WEEKO BARCELONA SL

Pol. Ind. La Valldan  
Camí de Garreta, 92  
08600 Berga  
Barcelona - Spain  
T. +34 93 824 90 20  
E. [info@weelko.com](mailto:info@weelko.com)