

Instructions Manual

Troch Smart

WKS029+.4.A26.HT

Electric Spa Bed

VERSION 1.25

1.Welcome!

Congratulations on purchasing this new spa bed. This manual is only for reference of using and operating this electric spa bed. Our company does not assume all the consequences and responsibilities caused by using this manual for other purposes.

All information in this manual is protected by kangmei copyright and no part of this manual may be copied, reproduced or translated without the written consent of kangmei company.

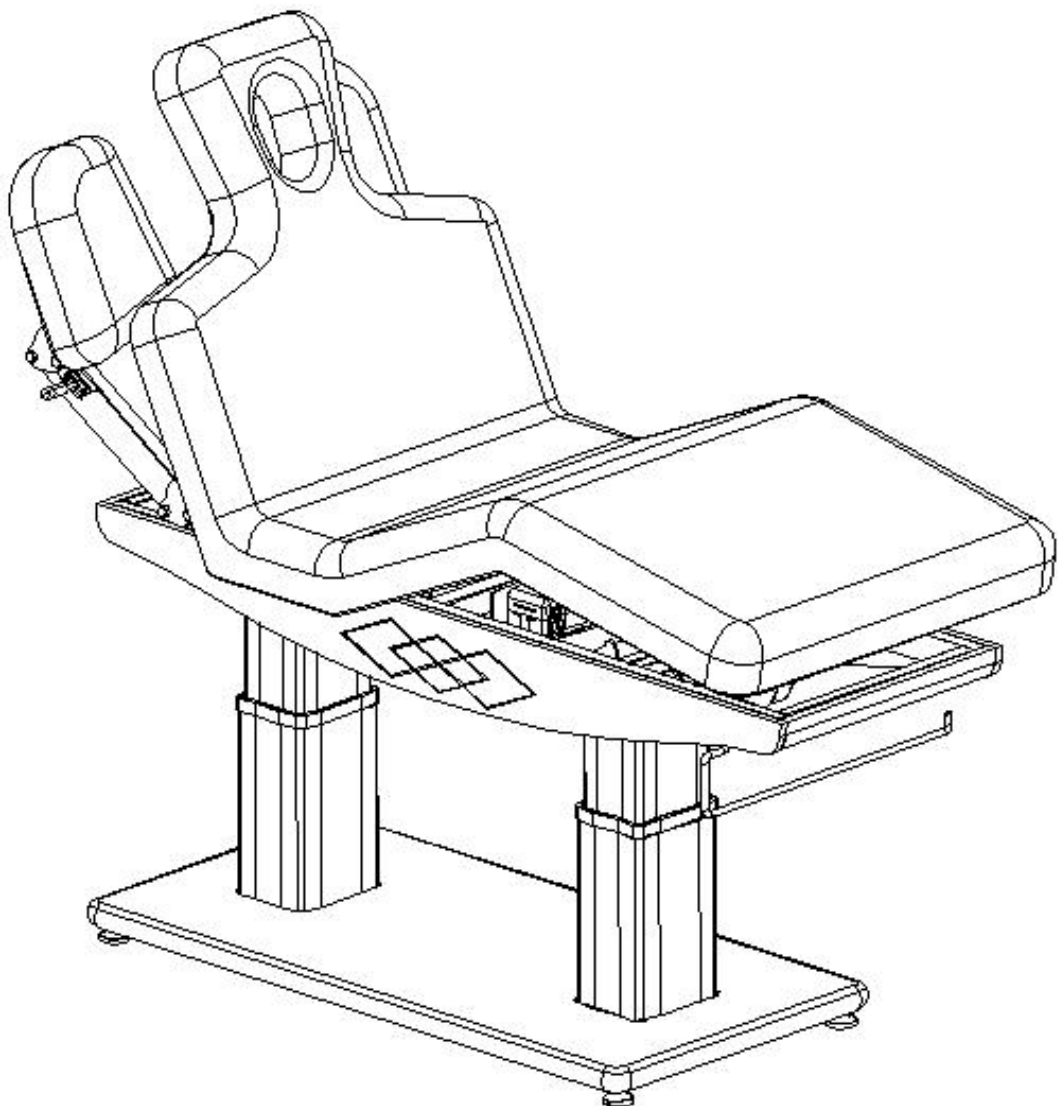

Imported by
WEELKO BARCELONA SL
Pol. Ind. La Valltan
Camí de Garreta, 92
08600 Berga
Barcelona - Spain
T. +34 93 824 90 20
E. info@weelko.com

2.Warning

- ☑ Power supply must be cut off when changing electrical components or maintaining and cleaning machines.
- ☑ The plug must be plugged into an outlet that is properly installed and grounded, to prevent the risk of fire and electric shock.
- ☑ Do not stand on this equipment.
- ☑ Do not allow children to play with and place the equipment in a place where children can avoid touching; Please adjust the backrest back to the highest position when you leave.
- ☑ Please do not place the equipment in damp places such as bathroom to avoid electric shock or other failure; The remote control should also avoid contact with water.
- ☑ Please do not place the equipment in places where painting/coating or oxygen providing during operation.
- ☑ Unless being monitored by guardians or instructed and responsible for their personal safety, the people who have physical obstacles, tactile disorders, mental disorders, lacking of experience, common sense or children, are not allow to use the equipment.
- ☑ Please contact distributor, or related manufacturerl with appropriate skill and experience for repairing if the plug is damaged, in case of any dangerous.

☑ Please make sure there is no accessible thing within the stroke during any operation of the beds.

☑ Maintenance should be processed by trained professionals.

3. Precautions

Read this manual carefully before installation, operation and adjustment, and please keep it well.

This electric beauty bed is equipped with a three-wire power cord. The power cord must be plugged into a three-hole outlet which is properly installed and grounded. This is not only to prevent the risk of electric shock, but also ensure bed work properly.

When adjusting the backrest, seat cushion, footrest or lifting of the whole bed by manual controller or foot control switch, please keep your hands, feet and head away from the position ①②③④ showed on below photo to avoid getting jammed.

While controlling the lifting of the whole bed, the button must be pressed continuously until the bed be in a suitable position.

Please pay attention that the input frequency should be $M_s \times 6\text{min/h}$ when operating the motor.

Maintenance should be processed by trained professionals.

Please use neutral reagent to clear the dust, stains on leather or on plastic cover after each treatment.

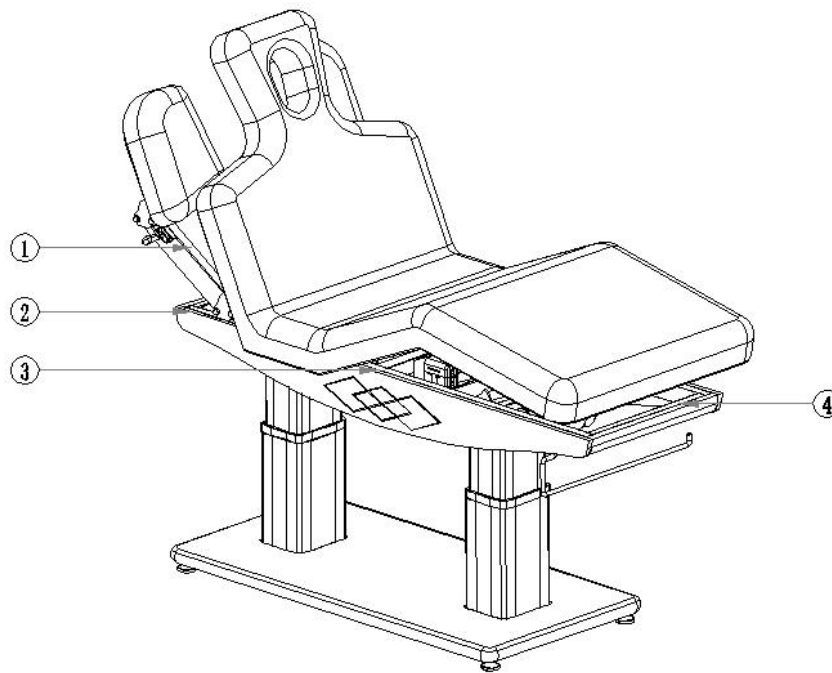

4. Structure of electric spa bed

This beauty bed consists of three motor controller box, motor, hardware, plastic parts and PU leather. Among them, the controller box is controlling the operation of three motors and hand controller.

This beauty bed includes angle adjustment of the backrest, angle adjustment of footrest and lifting adjustment of whole bed which is an overall and integral structure.

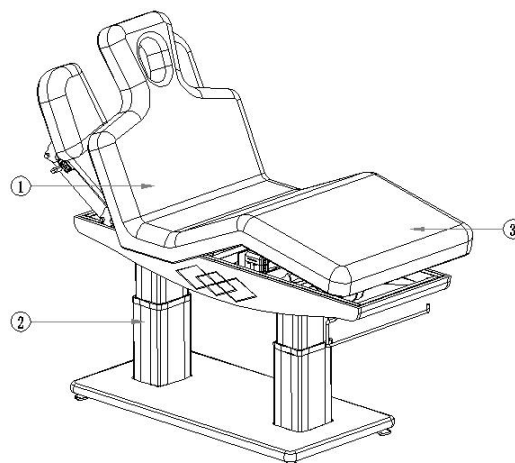

- ① Angle adjustment of the backrest
- ② Adjustment of the whole bed height
- ③ Angle adjustment of the footrest

This electric beauty bed is suitable for beauty and massage treatment.

5.Installation

① Put the bed to a proper location, according to the overall layout, the daylighting or artificial lightings and operation condition of the salon's or home. And keep it in the clean, dry and cool operating environment.

② Open the packing carton to check if the bed is intact and see if the accessories or spares are complete. Kindly contact distributor or manufacturer if any problem.

③ Place the bed to the proper position. Please note that it is unnecessary to install extra screw on the floor to fasten the bed, because the original design has take the stability performance into consideration. But please ensure the bed is placed on a firm and flat ground, so as to prevent any accident. If the bed rotates or slant due to rough ground, you could adjust the four pieces of plastic feet (M10×30) and nuts (M10) by hexagon open-end wrench, which are fasten on the bottom panel, so as to ensure the bed is stable.

④Power Input: Voltage and frequency input shall be AC 100-120V/60Hz, 220-240V/ 50Hz. Plug the bed on the power supply properly. (Details as shown below)

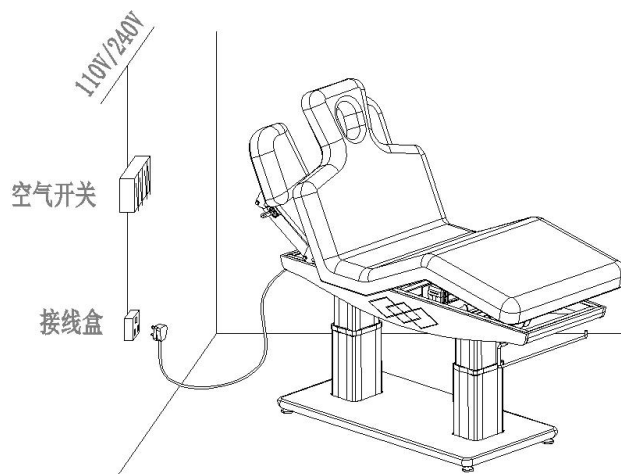

6.Operation instruction

Standard configuration (Instruction of Hand Control)

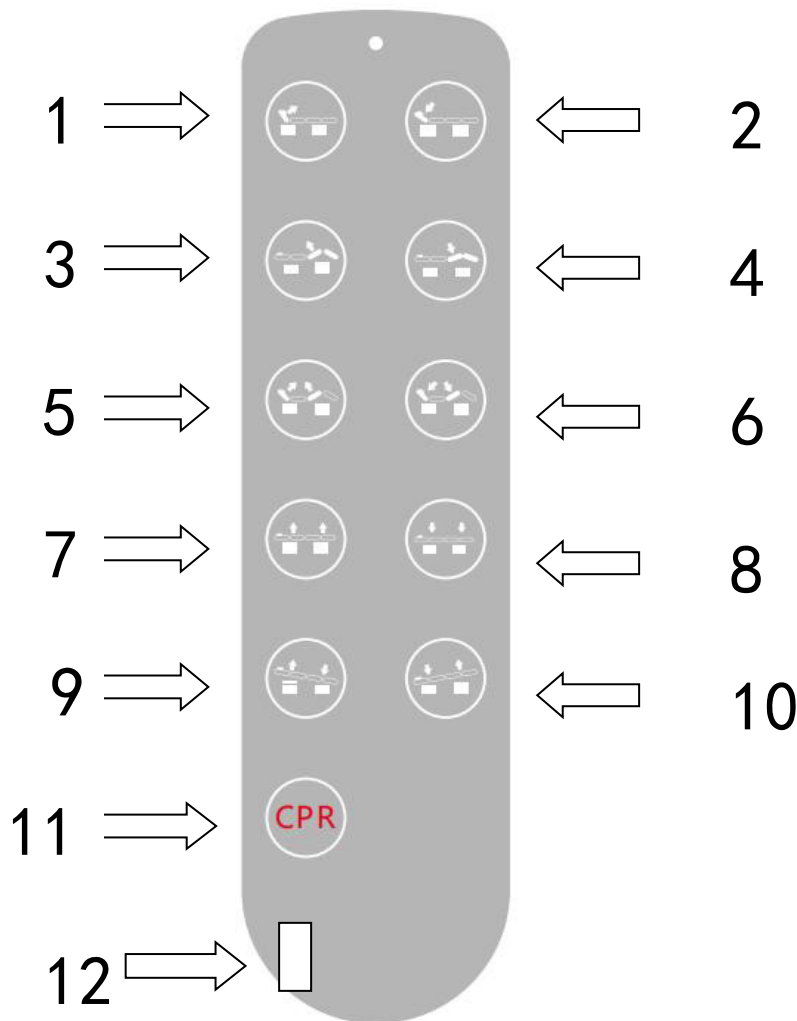

	Description	Operation
1	Backrest motor goes up	Backrest goes up smoothly by pressing the button.
2	Backrest motor goes down	Backrest goes down smoothly by pressing the button.
3	Footrest motor goes up	Footrest goes up smoothly by pressing the button.
4	Footrest motor goes down	Footrest goes up smoothly by pressing the button.
5	Backrest and Footrest motor goes up together	Backrest and Footrest goes up smoothly by pressing the button.
6	Backrest and Footrest motor goes down together	Backrest and Footrest goes down smoothly by pressing the button.
7	Whole bed motor goes up	The whole bed goes up smoothly by pressing the button.
8	Whole bed motor goes down	The whole bed goes down smoothly by pressing the button.
9	Whole-bed tilt (forward)	The whole bed forward tilt angle increases smoothly by pressing the button.
10	Whole-bed tilt (backward)	The whole bed backward tilt angle increases smoothly by pressing the button.
11	CPR	Press the button,the bed automatically move to flat and the height of the bed reach the minimum
12	Mechanical lock	Hand control will lose/restore power when key removal/ insertion.

7. Technical Parameters

Product size	1980(L) ×770(W) ×650(H) mm (±2%)
Package size	2020×820×680mm
The highest Position	850±10mm
The Lowest Postion	650±10mm
Net weight	132KG (±2KG)
Gross weight	145KG (±2KG)
Power	AC 100~120V ,50Hz/60Hz 或 AC 220~240V, 50Hz/60Hz可选
Backrest ajustment	0°~+64° (±10%)
Footrest ajustment	-25°~0° (±10%)
Tilt adjustment	15° (±10%)
Handrest adjustment height	165mm
Lifting rated load	200kg

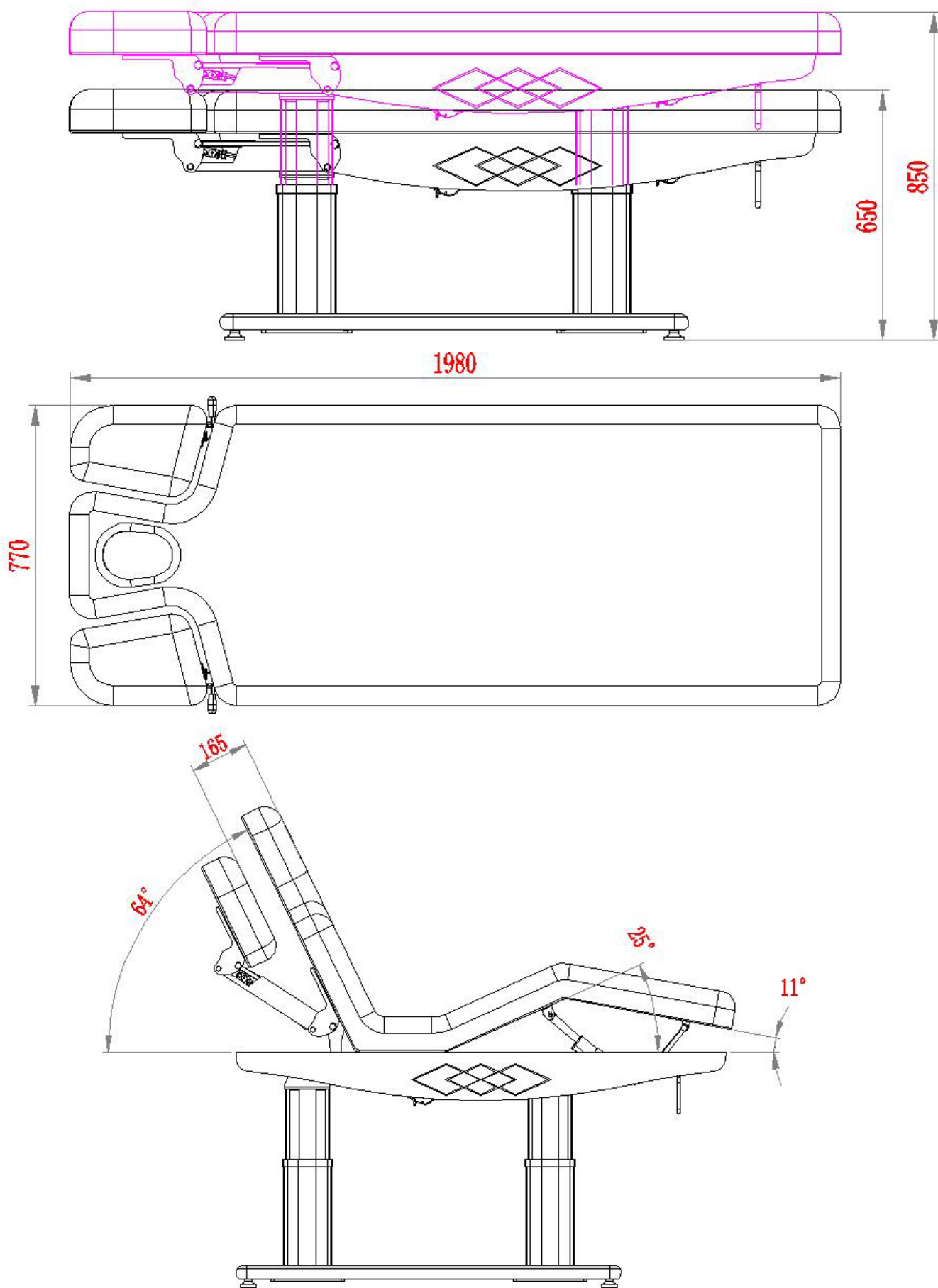

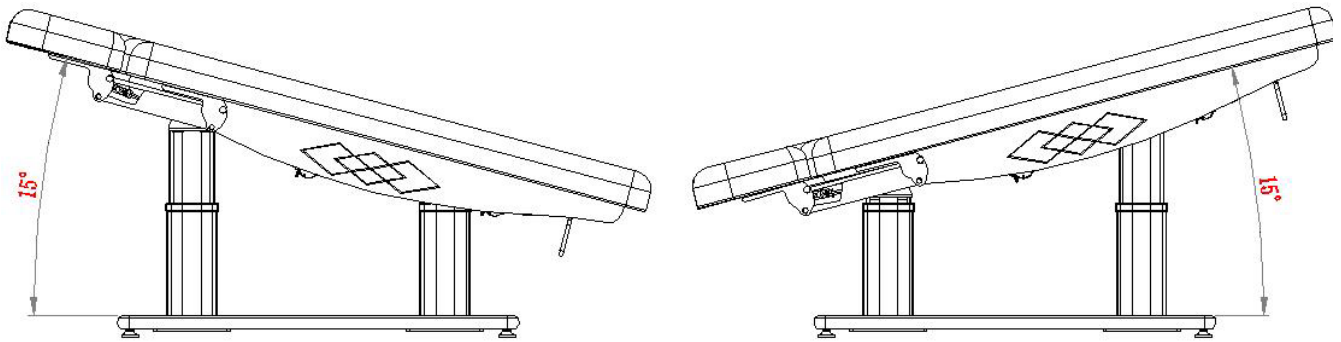

8.Maintenance

After every treatment, please use neutral reagent to clear the dust stains on leather or the plastic cover. This is to prevent premature aging of the leather and plastic cover.

9.Circuit system connection

AC 100-120V ,50Hz/60Hz 或 AC 220-240V ,50Hz/60Hz

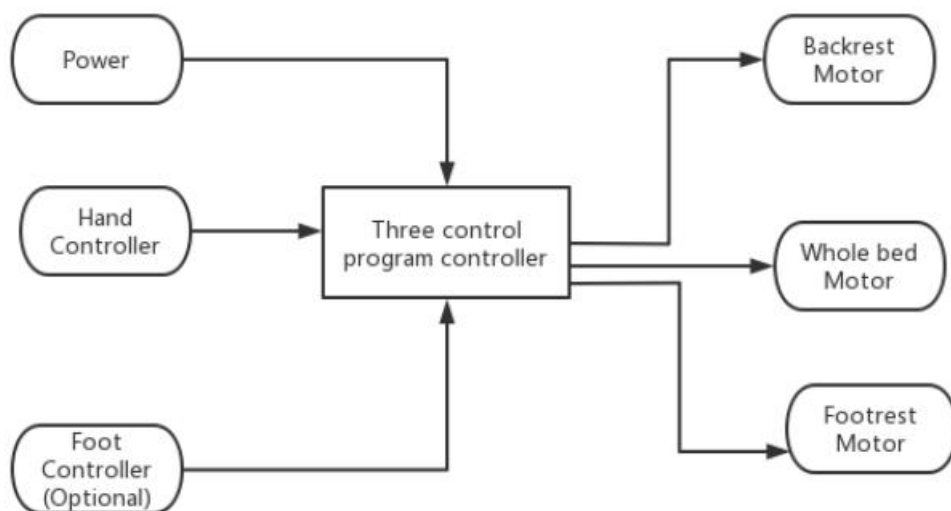

10.Troubleshooting

Problems	Reason	Solution
Can't go up or down normally	The power cord is unconnected or not well plugged	Connect the power cord or plug it well
	Poor quality of manual controller	Replace the manual control panel
	Poor quality of foot controller switch	If problem is still not solved after replacing manual or foot control switch, kindly contact maintenance center or supplier to clear the trouble.
	Poor quality of controller box	
	Rupture of motor tail	
	Motor detonation	
Abnormal sound	The rotating parts lack of lubricating oil	Add lubricating oil
	Rotating position (such as hinge, P, O, M sets) Lack of lubricating oil	Add lubricating oil
	Motor quality problems	Replace the motor

11. Icon explanation

	Warning note, refer to accompanying documents		Manufacturer
	Protective grounding		Maximum safe load
	Type B application part of the equipment		Upward
	Protection from rain		Separate disposal sign for waste electrical and electronic equipment (please comply with local laws and regulations)
	Battery		Place carefully and gently

Kindly check and verify products specifications before use and this manual is only used for reference. The product specifications will be subject to change or update without further notice.



Imported by
WEEKO BARCELONA SL
Pol. Ind. La Valldan
Cami de Garreta, 92
08600 Berga
Barcelona - Spain
T. +34 93 824 90 20
E. info@weelko.com